

## EXTERNAL LINKS

HD674-A027-E4x-xx



QR of Manual

---

[www.adfweb.com/download/  
filefold/MN674-A027\\_ENG.pdf](http://www.adfweb.com/download/filefold/MN674-A027_ENG.pdf)



QR of Box-Sheet

---

[www.adfweb.com/download/  
filefold/BS674-A027-E4x\\_  
ENG.pdf](http://www.adfweb.com/download/filefold/BS674-A027-E4x_ENG.pdf)



QR of Software

---

[www.adfweb.com/download/  
filefold/SW674-A027.zip](http://www.adfweb.com/download/filefold/SW674-A027.zip)

**HD674-A027-E4x-xx**

# BOX SHEET

## DMX / Modbus TCP Slave Converter

Box Sheet for Order code: HD674-A027-E4x-xx  
Document code: BS674-A027-E4x  
V1.000



**ADFweb.com srl**

Strada Nuova, 17, IT-31010 Mareno di Piave, Treviso - Italy

[www.ADFweb.com](http://www.ADFweb.com)

# CONNECTION SCHEME

Order code: HD674-A027-E4x-xx

## Connector3:

RS485 port



+ = Positive wire

- = Negative wire

Shl = Shield (to Isolated Ground)

## Connector2:

Ethernet Port  
(RJ45 Plug)

## Connector1:

Power Supply port



0V = Ground

+V = Positive wire

V AC: min 8V ; max 26V

V DC: min 10V ; max 40V

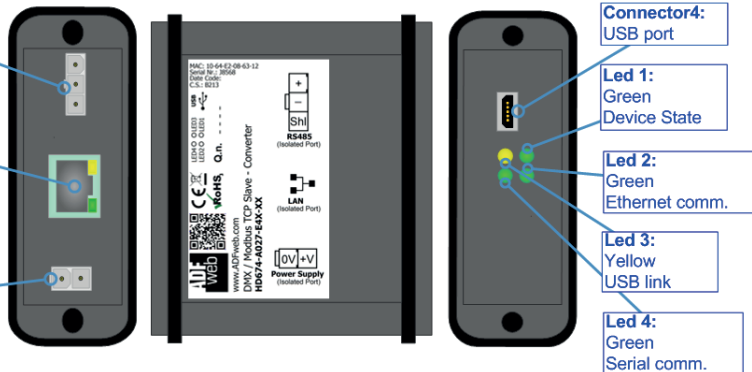

Order code: HD674-A027-E4x-xx